

49th Southeast

FIRE/RESCUE COLLEGE

February 8-12, 2023

www.robeson.edu/fireedu



Robeson Community College



Lumberton, North Carolina



In Loving Memory



Welton Locklear
1958 - 2022
Robeson County S.O.



Larry Morgan
1947 - 2022
Robeson County S.O.

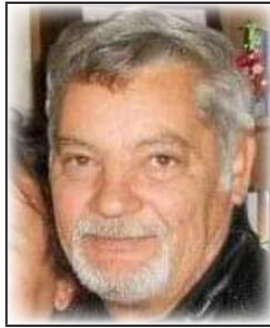

Junior McNeill
1958 - 2022
Pine Terrace F.D.



Huey Chavis
1939 - 2022
Burnt Swamp Phil. F.D.



Roger Parker
1952 - 2022
Lumberton Rescue



Billy Warwick
1967 - 2022
Robeson County EMS



Bruce West
1940 - 2022
East Howellsville F.D.



Mike Schneider
1952 - 2022
Lumberton Rescue



Erica Parks
1984 - 2022
Robeson County EMS



Gracie Wagner
(daughter of Brian Wagner)
Robeson County EMS



Jamie Adams
1949 - 2022
Lumberton Rescue



Derrick Lowry
1972 - 2022
Robeson County S.O.



Steve Britt
1953 - 2022
Orrum Township F.D.

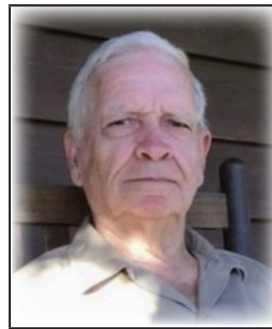

Lloyd Chambers
1933 - 2022
Lumberton Rescue



Carl Tyner
1956 - 2022
Med1 Services, LLC



Jimmie Britt, Sr
1937 - 2022
Big Marsh F.D.

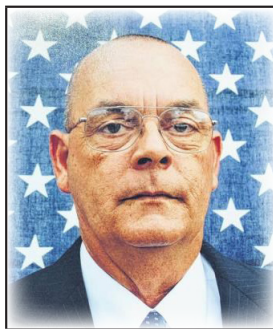

Charles Taylor
1959 - 2022
Allenton F.D.



Sammy Cox
1951 - 2022
R.C.C. Trustee



Rev. Anna Watson
1955 - 2022
Robeson County EMS

*Thank you for
your service.*

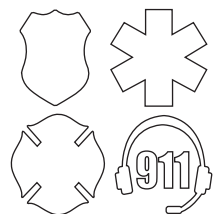

DEDICATION



Buddy Dial and Leo McMillan

Leo and Buddy have both served their communities with dedication and compassion for a total of over fifty years. Buddy served with Evans Crossroads Fire Department and Leo served with Shannon Fire Department. For most of their career, they have served as active and faithful members of the Southeast Fire Rescue College Planning Committee. They accepted every task and were instrumental in making the seminar a success each year. We recognize their contributions and wish them the best in retirement.



Paul Hayes

Assistant Chief Paul Hayes with Allenton Fire Department was struck by a vehicle while exiting a fire engine on the scene of a large woods fire on March 17, 2022. Chief Hayes sustained life threatening injuries and was flown from the scene to a trauma center. On April 20th, 2022, he was given a hero's escort to his home after being released from the hospital. He continues with physical therapy and is on the way to a full recovery. We recognize Chief Hayes for his dedication to his community and the fire service. Thank you.

REGISTRATION INFORMATION

\$35 for NC Emergency Services Personnel – all classes

Out of state/non-affiliated students must pay an additional fee. See below:

\$100 for classes 24 hours or less.

\$125 for classes over 24 hours.

Registrations can be mailed, emailed or faxed with credit card information, which is located at the bottom of the registration form. Payment is required when submitting registrations! If mailing, use Post Office Box 1404, Lumberton, NC, 28359.

When completing the registration form, use the class number to indicate your choice of classes. You can pick up to four choices.

Class Check-in: Room assignments will be posted at the registration desk in building 13, the student center. All classes, with the exception of a few, will be held on main campus. You must be present the first day of class in order to register. Please be on time.

Certificates: The college does not issue attendance certificates. Certification class grades will be submitted to NC OSFM and should show on your transcript within 30 days of course completion. Students who fail a course will be notified by letter.

Emergencies: During class hours, dial (910) 272-3338.

Refunds will not be given for **any** reason. If you cannot attend, another student may attend in your place provided you call ahead and notify us of the change at (910) 272-3330.

Class cancellations will be made **January 16**. If you do not receive your first choice, you will be notified of your new class assignment. **Clearly** write your email address on your registration form, as well as a contact telephone number.

Smoking and the use of tobacco products are prohibited on any RCC Campus.

Questions? Call 910-272-3330 or 910 272-3329.

SCHEDULE OF CLASSES

Wednesday February 8, 2023

| | |
|-----|--|
| 1pm | TR Machinery and Ag Rescue (ESTC) |
| 1pm | Hazardous Materials Operations (Main Campus) |
| 1pm | Fire Officer 1 (Main Campus) |
| 1pm | NIMS 300 (Main Campus) |

Thursday February 9, 2023

| | |
|-----|---|
| 1pm | FF Ops 3 (Main Campus) |
| 1pm | FF Ops 4 (Main Campus) |
| 1pm | FF Ops 5 (Main Campus) |
| 1pm | FF Ops 6 (Main Campus) |
| 1pm | FF Ops 9 (Training Center) |
| 1pm | Fire Officer II (Main Campus) |
| 1pm | Driver Operator Intro to Pumps (Main Campus) |
| 1pm | Driver Operator Pump Hydraulics (Main Campus) |
| 1pm | Driver Operator Sprinklers and Standpipes/Testing (Main Campus) |

Friday February 10, 2023

| | |
|----------|---|
| 1pm | Additional classes begin (Main Campus) |
| 6pm | Remaining classes begin (Main Campus) |
| 6pm-10pm | Vendors - Fred G. Williams Student Center-Bldg. 13 |

Saturday February 11, 2023

| | |
|------------|---|
| 8am-6pm | Vendors – Fred G. Williams Student Center-Bldg. 13 |
| 8am-830am | Classes begin (Main Campus) |
| 1130am-1pm | Lunch on your own (Please patronize area restaurants) |

Sunday February 12, 2023

| | |
|-----------|---|
| 730am-8am | Devotion – Building 18 (BB&T Room) |
| 8am-12pm | Vendors - Fred G. Williams Student Center-Bldg. 13 |
| 8am | Classes begin |

CHECK REGISTRATION DESK IN BUILDING 13 FOR ROOM ASSIGNMENTS

SPECIALTY NON-CERTIFICATION

1. When Moving Vehicles Should Be Your First Option
2. Fireground Survival
3. Grain Bin Rescue

FIREFIGHTER CERTIFICATION

4. FF General and Communications
5. FF Fireground Ops 1
6. FF Fireground Ops 2
7. FF Fireground Ops 3
8. FF Fireground Ops 4
9. FF Fireground Ops 5
10. FF Fireground Ops 6
11. FF Fireground Ops 7
12. FF Fireground Ops 8
13. FF Fireground Ops 9
14. FF Rescue Ops 1
15. FF Fire and Life Safety Initiatives
16. Mayday/Safety and Survival
17. FF/TR Emergency Medical Care

TECHNICAL RESCUER CERTIFICATION

18. TR Rope Basics
19. TR Rescue Operations
20. TR Victim Management
21. TR Machine and Agricultural Rescue

DRIVER/OPERATOR CERTIFICATION

22. Driver Operator Pumps Introduction/Basic Operations
23. Emergency Vehicle Driver
24. Driver Operator Hydraulics/Water Supplies
25. Driver Operator Sprinklers/Maintenance and Testing
26. Mobile Water Supply

HAZMAT CERTIFICATION

27. Hazardous Materials Operations

NIMS

28. NIMS 300
29. NIMS 400

SPECIALTY CERTIFICATION

30. Chief 101
31. Chief 101 Refresher
32. Fire Officer I
33. Fire Officer II

CODE ENFORCEMENT CERTIFICATION

- 34. Law & Administration

EMS

- 35. NC EMS Leadership Academy
- 36. Critical Incident Stress Debriefing
- 37. NAEMT Tactical Emergency Casualty Care (TECC)
- 38. NAEMT Prehospital Trauma Life Support (PHTLS)
- 39. NAEMT Advanced Medical Life Support (AMLS)

NATIONAL FIRE ACADEMY

- 40. Initial Fire Investigations for First Responders
- 41. Leadership in Supervision: Creating Environments for Personal Growth
- 42. Leadership in Supervision: Perspectives in Thinking

NON-CERTIFICATION

- 43. Explosives, Bombs & Booby Traps
- 44. Fatal Fire Investigations
- 45. Advanced Fire Firefighting
- 46. NFPA 1403 Academy
- 47. Land Navigation
- 48. NC Rating Response System
- 49. ERDI 1 and Dive Tender Operations

NOTICE TO STUDENTS

Effective July 1, 2019, all students participating in live fire training are required to be eighteen years of age and have met the minimum requirements for NFPA 1403. The chief or training officer of the department will be required to sign off on students who have met the minimum requirements before they can participate. A copy of the required form is located on the back of the registration form.

All students attending classes for certification through the NC Office of State Fire Marshal are required to have proper identification with them, as verification is required before being administered a certification test.

Any questions or concerns, please call the training center at 910-272-3330.



SPECIALTY NON-CERTIFICATION

1. WHEN MOVING VEHICLES SHOULD BE YOUR FIRST OPTION (14 hours)

Friday 630pm-830pm, Saturday 8am-5pm & Sunday 8am-12pm

This class will consist of real-world tactics which are used to move vehicles in a controlled and safe manner while still occupied. The class will also demonstrate how to give up a few minutes on the front end of an extrication to gain time back in an extrication. Multiple rescue tools will be utilized.

(PPE Required)

Instructor: Toranze "Toot" Lee with Premier Extrication

2. FIREGROUND SURVIVAL (16 hours)

Saturday 8am-5pm & Sunday 8am-5pm

This class is totally hands on and will encompass training on forcible entry, wall breeches, below grade firefighter retrieval, Denver drill, victim removal and downed firefighter CPR. **(PPE Required)**

Instructors: Box 1971 LLC

3. GRAIN BIN RESCUE (12 hours)

Friday 6pm-10pm, Saturday 8am-5pm

This hands-on program will allow students to experience working in and around grain bins safely. Students will learn the four main reasons for grain entrapment and how to rescue a victim from a partial or full entrapment.

Instructor: TBA

FIREFIGHTER 2019 CERTIFICATION

Students must provide appropriate personal protective equipment for all classes.

4. FF General and Communications (24 hours)

Friday 1pm-10pm, Saturday 8am-6pm & Sunday 8am-4pm

This block of instruction covers orientation and fire service communications.

5. FF Fireground Ops 1 (24 hours)

Friday 1pm-10pm., Saturday 8am-6pm & Sunday 8am-4pm

This block of instruction covers firefighter health and safety.

6. FF Fireground Ops 2 (24 hours)

Friday 1pm-10pm, Saturday 8am-6pm & Sunday 8a-4pm

This block of instruction covers firefighter personal protective equipment.

7. FF Fireground Ops 3 (32 hours)

Thursday 1pm-10pm, Friday 8am-6pm, Saturday 8am-6p, & Sunday 8am-3pm

This block of instruction covers building construction, portable extinguishers and fire behavior.

8. FF Fireground Ops 4 (32 hours)

Thursday 1pm-10pm, Friday 8am-6pm, Saturday 8am-6p, & Sunday 8am-3pm

This block of instruction covers tools, forcible entry and loss control.

9. FF Fireground Ops 5 (32 hours) Report directly to the training center

Thursday 8am-6pm, Friday 8am-6pm, Saturday 8am-6pm & Sunday 8am-2pm

This block of instruction covers ladders and ventilation.

10. FF Fireground Ops 6 (24 hours)

Friday 1pm-10pm, Saturday 8am-6pm & Sunday 8am-4pm

This block of instruction covers ropes, knots and search and rescue.

11. FF Fireground Ops 7 (24 hours)

Friday 1pm-10pm, Saturday 8am-6pm & Sunday 8am-4pm

This block of instruction covers water supplies.

12. FF Fireground Ops 8 (24 hours)

Friday 1pm-10pm, Saturday 8am-6pm & Sunday 8am-4pm

This block of instruction covers fire hose, streams and appliances,

13. FF Fireground Ops 9 (32 hours) Report directly to the training center

Thursday 1pm-11pm, Friday 8am-6pm, Saturday 8am-6pm & Sunday 8am-2pm

This block of instruction covers fire control. All students are required to bring a signed live fire course competency validation form with them on the first day of class.

14. FF Rescue Ops 1 (24 hours)

Friday 1pm-10pm, Saturday 8am-6pm & Sunday 8am-4pm

This block of instruction covers rescue in the fire service.

15. FF Fire and Life Safety Initiatives (24 hours)

Friday 1pm-10pm, Saturday 8am-6pm & Sunday 8am-4pm

This block of instruction covers detection and suppression systems and fire & life safety initiatives.

16. Mayday and Safety and Survival (24 hours)

Friday 1pm-10pm, Saturday 8am-6pm & Sunday 8am-4pm

17. FF/TR Emergency Medical Care (12 hours)

Friday 630pm-1030pm & Saturday 8a-5pm

This block of instruction covers first aid, CPR and AED.



TECHNICAL RESCUER CERTIFICATION

Students must provide appropriate personal protective equipment for all classes.

18. TR RESCUE OPERATIONS (14 hours)

Friday 7pm-10pm., Saturday 8am-4pm & Sunday 8am-12pm

This course will present the Technical Rescuer (TR) with the requirements for pre-planning, scene size-up, and hazards assessment for incidents involving rope rescue. This course will also introduce the Technical Rescuer to applicable standards addressing rope rescue, Personal Protective Equipment (PPE), accessory gear, rope software, and rope hardware. NFPA 1006 Chapters 5 and 6.

19. TR ROPE BASICS (14 hours)

Friday 7pm-10pm., Saturday 8am-4pm & Sunday 8am-12pm

This course will present to the Technical Rescuer (TR) safe and effective methods of rescue in elevated and below grade environments using ropes, knots, and rope related equipment. Mechanical advantage, anchors, anchoring techniques, and stress loads will be covered. NFPA 1006 Chapters 5 and 6.

20. TR VICTIM MANAGEMENT (16 hours)

Friday 630pm-1030pm, Saturday 830am-530pm & Sunday 8am-12pm

The course will present to the Technical Rescuer (TR) the safe and effective methods of rescuing a victim using multiple scenarios. NFPA 1006 Chapters 5 and 6.

21. TR MAG MACHINERY AND AG BLOCK (40 hours)

Wednesday 1pm-10pm, Thursday 8am-6pm, Friday 8a-6pm, Saturday 8am-6pm & Sunday 8am-1pm

REPORT DIRECTLY TO THE EMERGENCY SERVICES TRAINING CENTER

*****Class is limited to 30 students*****

This block course will present the Technical Rescuer with the knowledge, skills, and abilities to satisfy the requirements of Chapter 19 (Machinery) of NFPA 1006: Standard for Technical Rescue Professional Qualifications. In addition, this course covers agricultural-related emergencies and how to mitigate those responses.

NOTE: A NC FIRE AND RESCUE COMMISSION CERTIFICATION FOR THIS CLASS WILL ONLY BE GIVEN TO THE STUDENT WHO CURRENTLY HOLDS A TR VEHICLE AND TR ROPES CERTIFICATION.



Like and follow us on Facebook!

Robeson Community College Emergency Services Training Center

DRIVER/OPERATOR CERTIFICATION

Students must provide appropriate personal protective equipment for all classes.

22. PUMPS INTRODUCTION AND BASIC OPERATIONS (30 hours)

Thursday 1pm-10pm, Friday 8am-5p, Saturday 8am-5p & Sunday 8am-3pm

23. EMERGENCY VEHICLE DRIVER (24 hours)

Friday 1pm-10pm, Saturday 8am-6pm & Sunday 8am-4pm

Pre-requisite: A copy of your valid driver's license must be given to instructor in class

24. PUMPS HYDRAULICS AND WATER SUPPLY (30 hours)

Thursday 1pm-10pm, Friday 8am-5p, Saturday 8am-5p & Sunday 8am-3pm

25. PUMPS SPRINKERS, STANDPIPES AND MAINTENANCE AND TESTING (28 hours)

Thursday 1pm-10pm, Friday 8am-5pm, Saturday 8am-5p & Sunday 8am-12pm

26. MOBILE WATER SUPPLY (28 hours)

Thursday 1pm-10pm, Friday 8am-5pm, Saturday 8am-5p & Sunday 8am-12pm



HAZMAT CERTIFICATION

27. HAZARDOUS MATERIALS OPERATIONS (40 hours)

Wednesday 1pm-10pm, Thursday 8am-6pm, Friday 8a-6pm, Saturday 8am-6pm & Sunday 8am-1pm

This course meets OSFM's training requirements for the Hazardous Materials Operations credential. Course content includes lecture and practice activities needed to perform the following tasks safely and effectively:

(1) implement standard operating procedures in the current edition of the DOT Emergency Response Guidebook; (2) analyze hazardous materials/WMD incident; (3) plan an initial response to a hazardous materials/WMD incident; (4) implement the planned response for a hazardous materials/WMD incident; (5) evaluate the progress of the actions taken at a hazardous materials/WMD incident.

Needs: Full PPE

NIMS

You must register with NC Emergency Management TERMS @ <http://terms.ncem.org/TRS/> to receive your NC Emergency Management certificate.

28. NIMS 300 (21 hours)

Wednesday 1pm-10pm, Thursday 830am-530pm & Friday 830am-230pm

This course is for persons at mid-level management serving as command staff, section chiefs, strike team leaders, task force leaders, unit leaders, division/group supervisors, branch directors, and multi-agency coordination system/emergency operations center staff.

29. NIMS 400 (15 hours)

Saturday 830am-530pm & Sunday 830am-1630pm

This advanced Incident Command System (ICS) course is designed to explain how major incidents engender special management challenges, describe the circumstances in which an Area Command is established, and describe the circumstances in which multi-agency coordination systems are established.



Scan our QR code to find classes scheduled all year!

SPECIALTY CERTIFICATION

30. CHIEF 101 (8 hours)

Saturday 830am – 530pm

This class will satisfy the 9S inspection criteria as specified by the North Carolina Administrative Code. The primary objective of the course is to inform current and future chief officers of the various aspects and complexities surrounding the operations and organization of North Carolina fire departments. Emphasis will be placed on ratings and inspections, NFIRS reporting, prevention and grant programs, basic line-of-duty death information, financial considerations, and an overview of the various expectations facing a chief officer.

31. CHIEF 101 REFRESHER (4 hours)

Friday 600pm-10pm

Refresher course for those who have already taken the full 8-hour course.

32. FIRE OFFICER I (40 hours)

Wednesday 1pm-10pm, Thursday 8am-6pm, Friday 8a-6pm, Saturday 8am–6pm & Sunday 8am–1pm

This course identifies the performance requirements necessary to perform the duties of a first line supervisor. This course introduces the student to the basic concept of management and supervision. Upon completion, the individual will be able to supervise, instruct, and direct members of the fire department in both emergency and non-emergency situations.

Needs: Company Officer Fifth Edition IFSTA

33. FIRE OFFICER II (32 hours)

Thursday 1pm-10pm, Friday 8a-6pm, Saturday 8am–6pm & Sunday 8am–3pm

This course will present the knowledge, skills and ability to satisfy the requirements of the Chapter V of the NFPA 1021: Standard for Fire Officer Professional Qualifications. This course is designed to meet the needs of the mid-level officer/supervisor.

Needs: Company Officer Fifth Edition IFSTA

CODE ENFORCEMENT CERTIFICATION

34. LAW & ADMINISTRATION (15 hours)

Friday 7pm-10pm., Saturday 830am-5pm & Sunday 8am-1pm

This course is designed to provide a basic understanding of the governmental and legal system with which every code enforcement official works. The course satisfies the training requirements to gain admission to the state qualifying exam. Students are to furnish their own textbook "Administration Code and Policies" of the North Carolina State Building Code, latest edition.

EMS

35. The NC EMS Leadership Academy 2/8/23 – 2/12/23 0800-1800

The NC EMS Leadership Academy content is designed to provide comprehensive, interactive, instruction in essential areas of EMS system management. Topics provide insight into relevant EMS scenarios and are taught by professionals with extensive experience or actively involved in the day-to-day leadership of NC EMS systems.

The Academy provides an intensive training experience delivered in two sessions over the course of six months. Each session is 40 hours in length. The second session will be held in the Fall.

Topics covered in the Academy include:

| | |
|---|---|
| <ul style="list-style-type: none">• Transition from Field to Officer• Human Resources Management• Customer Service/Community Relations• Branding• Partnerships• Local Government Interaction• Communication• Managerial Leadership• Culture• Reimbursement and Patient Records• Strategic Deployment and System Designs• Financial Forecasting EMS Law, Legal Liability and Case Reviews | <ul style="list-style-type: none">• Information Technology• Fleet Maintenance• Logistics• Supply & Equipment Management• Safety and Risk Management Best Practices• Safety Culture• Risk Management• Conflict Resolution• Dealing with Fatigue• Field Training Programs• Incident Investigation• Disaster Planning and Emergency Preparedness• |
|---|---|

Two step registration for this class! First: Register and pay \$125 for books and supplies with EMS Wizard @ <https://www.emswizard.com/home/nc-ems-leadership-academy/ncemsla-program/> Once completed, they will be directed back to us for RCC registration.

36. Critical Incident Stress Management Training 2/10/23 – 2/12/23 0800 – 1700

THIS COURSE IS DEDICATED TO THE MEMORY OF MR. BILLY WARWICK

The CISM GRIN Class is a combination of both the Individual Crisis Intervention and Peer Support & Group Crisis Intervention. This course is designed for EAP, human resources and public safety personnel, mental health professionals, chaplains, emergency medical services providers, firefighters, physicians, police officers, nurses, dispatchers, airline personnel and disaster workers who are already trained in the critical incident stress debriefing format. It will also be useful for those working extensively with traumatized victims for various walks of life. Additional Fees: Books \$55. Certificate \$5. Limited scholarships available to cover these fees.

36. NAEMT - Tactical Emergency Casualty Care (TECC) 2/9/23 – 2/10/23 0800 – 1700

The 2nd edition of NAEMT's Tactical Emergency Casualty Care (TECC) course teaches EMS practitioners and other prehospital providers how to respond to and care for patients in a civilian tactical environment. The course presents the three phases of tactical care and integrates parallel EMS nomenclature: Hot Zone/Direct Threat Care that is rendered while under attack or in adverse conditions. Warm Zone/Indirect Threat Care that is rendered while the threat has been suppressed but may resurface at any point. Cold Zone/Evacuation Care that is rendered while the casualty is being evacuated from the incident site.

The 16-hour classroom course includes all new patient simulations and covers the following topics:
Hemorrhage control including immediate action drills for tourniquet application throughout the course;
Complete coverage of the MARCH assessment; Surgical airway control and needle decompression; Strategies for treating wounded responders in threatening environments;
Caring for pediatric patients; Techniques for dragging and carrying victims to safety; and
A final, mass-casualty/active shooter event simulation.

NAEMT's TECC course is endorsed by the American College of Surgeons Committee on Trauma, is consistent with the current guidelines established by the Committee on TECC (Co-TECC), and meets all of the updated National Tactical Emergency Medical Support Competency Domains. This course is accredited by CAPCE for 16 hours of continuing education credit, and recognized by NREMT. This course is ideal for Law, BLS, and ALS providers. Additional Fees: Certification \$15.

37. NAEMT - Tactical Emergency Casualty Care (TECC) 2/11/23 – 2/12/23 0800 – 1700

The 2nd edition of NAEMT's Tactical Emergency Casualty Care (TECC) course teaches EMS practitioners and other prehospital providers how to respond to and care for patients in a civilian tactical environment. The course presents the three phases of tactical care and integrates parallel EMS nomenclature: Hot Zone/Direct Threat Care that is rendered while under attack or in adverse conditions. Warm Zone/Indirect Threat Care that is rendered while the threat has been suppressed but may resurface at any point. Cold Zone/Evacuation Care that is rendered while the casualty is being evacuated from the incident site.

The 16-hour classroom course includes all new patient simulations and covers the following topics:
Hemorrhage control including immediate action drills for tourniquet application throughout the course;
Complete coverage of the MARCH assessment; Surgical airway control and needle decompression; Strategies for treating wounded responders in threatening environments;
Caring for pediatric patients; Techniques for dragging and carrying victims to safety; and
A final, mass-casualty/active shooter event simulation.

NAEMT's TECC course is endorsed by the American College of Surgeons Committee on Trauma, is consistent with the current guidelines established by the Committee on TECC (Co-TECC), and meets all of the updated National Tactical Emergency Medical Support Competency Domains. This course is accredited by CAPCE for 16 hours of continuing education credit, and recognized by NREMT. TECC is appropriate for BLS and ALS providers. Additional Fees: Certification \$15.

38. NAEMT – Prehospital Trauma Life Support (PHTLS) 2/9/23 – 2/10/23 0800 – 1700

NAEMT's Prehospital Trauma Life Support (PHTLS) is recognized around the world as the leading continuing education program for prehospital emergency trauma care. The mission of PHTLS is to promote excellence in trauma patient management by all providers involved in the delivery of prehospital care. PHTLS is developed by NAEMT in cooperation with the American College of Surgeons' Committee on Trauma. The Committee provides the medical direction and content oversight for the PHTLS program.

PHTLS courses improve the quality of trauma care and decrease mortality. The program is based on a philosophy stressing the treatment of the multi-system trauma patient as a unique entity with specific needs. PHTLS promotes critical thinking as the foundation for providing quality care. It is based on the belief that, given a good fund of knowledge and key principles, EMS practitioners are capable of making reasoned decisions regarding patient care.

PHTLS is appropriate for EMTs, paramedics, nurses, physician assistants, physicians, and other prehospital providers. Additional Fees: Certification \$15.

39. NAEMT – Advanced Medical Life Support (AMLS) 2/11/23 – 2/12/23 0800 – 1700

Advanced Medical Life Support (AMLS) remains the gold standard of education for emergency medical assessment and treatment. Endorsed by the National Association of EMS Physicians, AMLS emphasizes the use of the AMLS Assessment Pathway, a systematic tool for assessing and managing common medical conditions with urgent accuracy.

In the third edition of AMLS, students learn to recognize and manage common medical crises through realistic case-based scenarios that challenge students to apply their knowledge to highly critical patients. The course emphasizes the use of scene size-up, first impression, history, interactive group discussion on differential diagnosis and potential treatment strategies, and physical exam to systematically rule out and consider possibilities and probabilities in treating patients' medical crises. The third edition AMLS library of patient simulations offers students an opportunity to apply critical thinking skills to a variety of patient presentations.

AMLS is appropriate for EMTs, paramedics, nurses, physician assistants, physicians, and other prehospital providers. Additional Fees: Certification \$15.

Questions on these classes?

Contact Brad Lawson at blawson@robeson.edu



NATIONAL FIRE ACADEMY

A National Fire Academy SID (Student Identification) number is required for any NFA class. You must have your SID number with you if you plan to attend any of the following classes. Please obtain your SID number at <http://www.usfa.fema.gov/nfa/about/attend/ftin.shtm>

40. INITIAL FIRE INVESTIGATIONS FOR FIRST RESPONDERS (16 hours)

Friday 6pm-10pm, Saturday 8am-5pm & Sunday 8am-12pm

This course provides a clear definition of the role of initial responder to recognize the potential of an intentionally set fire, preserve evidence, and properly report the information to appropriate officials. Basic topics include: fire behavior, critical observations of the first responder, fire cause, scene security and evidence preservation, legal considerations, and the reporting of findings.

41. LEADERSHIP IN SUPERVISION: CREATING ENVIRONMENTS FOR PROFESSIONAL GROWTH (16 hours)

Friday 6pm-10pm, Saturday 8am-5pm & Sunday 8am-12pm

This course presents the supervisor with the basic leadership skills and tools needed to perform effectively in the fire service environment and includes concepts related to a successful transition to supervisory and leadership roles, including concepts of adaptive leadership; change management; active followership; effective communication, including difficult conversations and advocacy-inquiry-based dialogue; ethics; authority; power; decision making; and active engagement through development of a personal plan.

42. LEADERSHIP IN SUPERVISION: PERSPECTIVES IN THINKING (16 hours)

Friday 6pm-10pm, Saturday 8am-5pm & Sunday 8am-12pm

This course provides the supervisor with the conceptual foundation and framework for success in leadership roles by exploring creative, analytical, political and critical thinking perspectives and addresses skills needed for assessing situations from multiple perspectives, making critical decisions, fostering creativity and innovation, and using persuasion.





NON-CERTIFICATION

43. EXPLOSIVES, BOMBS & BOOBY TRAPS (15 hours)

Friday 7pm-10pm., Saturday 830am – 500pm & Sunday 800am-1pm

This class takes Emergency First Responders (EMS, Fire, Law Enforcement, and Rescue) through basic understandings of explosives, explosive environments and understanding how they function. The latest Improvised Explosive Devices (IEDs) being employed overseas and domestically, how they are constructed, the damage they can cause, and how they are being used by terrorists against first responders. Also, what first responders can do to ensure their safety against this new threat. The course will take the students through bomb threats, searches, and booby traps, all of which they may encounter in their jobs. It will also discuss ways to discover terrorist methods, activities and the latest cases and ways they can help stop future events in the U. S. This course will be presented through classroom instruction and practical exercises including bomb searches, booby trapped trails, and live explosive demonstrations.

44. FATAL FIRE INVESTIGATIONS (12 hours)

Saturday 830am – 500pm & Sunday 800am – 1pm

This course aids in all parts of fire and law enforcement investigations into any type of fatal fire and will go over many avenues of responsibility of each party and will help everyone with the scene and follow up.

45. ADVANCED FIREFIGHTING TECHNIQUES (20 hours)

Friday 1pm-10pm, Saturday 8am-5pm & Sunday 8am-12pm

Minimum age requirement is 18 years old. Full PPE with SCBA is required.

This course is designed for the experienced firefighter to practice suppression techniques in a variety of live fire scenarios. Instructors will incorporate the use of LP gas props, rail car, burn trailer and class A burn building. **NC OSFM Live Fire Course Competency Validation Form 200.14a (on the back of the registration form) MUST be completed in order to enroll!**

46. NFPA 1403 ACADEMY (22 hours)

Friday 1pm-10pm, Saturday 8am-6pm & Sunday 8am-1pm

This course is designed for the firefighter with little or no experience. Basics to be covered include fire streams, SCBA, hose practices, building construction, ladders and fire behavior. Practical applications will be used. This class meets the minimum qualifications for NFPA 1403.

Needs: Full PPE

47. LAND NAVIGATION (20 hours)

Friday 6-10 p.m., Saturday 8 a.m. – 7 p.m., & Sunday 8 a.m. – 2 p.m.

This class will consist of the use of GPS and compass over terrain and how to determine your location while on a mission. There will be practical exercises for the student to become familiar with both of these tools for search activities.

Needs: Compass

48. NC RATING RESPONSE SYSTEM (12 hours)

Saturday 830am – 500pm & Sunday 800am-1pm

A representative from the NC Department of Insurance will discuss the new rating response system program and how it relates to the ISO system. Learn how your department will be rated in the future.

Needs: Calculator, paper, No. 2 pencils, map of your service area with all hydrants, and apparatus inventories on all trucks in your department.

49. ERDI 1 AND DIVE TENDER OPERATIONS (22 hours)

Friday 6pm-10pm, Saturday 8am-9pm & Sunday 8am-3pm

This rescue diver certification is designed to develop the knowledge and necessary skills for an individual to effectively perform diver rescues and assists, the function of a dive tender, and performing underwater search patterns.

Note: Class will meet on main campus Friday evening and be at off site locations Saturday and Sunday.



ROBESON COUNTY BOARD OF COMMISSIONERS



Wixie Stephens, Chairman
Tom Taylor, Vice Chair
Pauline Campbell
David Edge
Lance Herndon
Wixie Stephens
Judy Sampson
John Cummings
Faline Dial



Kelli Blue, **County Manager**

Thank you for your continued support of



As always, a special thank you also to Chris Ivey and Tasha Hunt Ivey for help in designing this year's brochure!

SOUTHEAST FIRE/RESCUE COLLEGE PLANNING COMMITTEE

Danielle Burnette,.....Qualified Assistant, RCC Fire & Rescue Training
Randy Carlyle.....President, Robeson County Rescue Association
Justin Hunt..... Assistant Director, Robeson County Emergency Management
Stephanie ChavisRobeson County Fire Marshal & Director, Robeson County Emergency Management
Christina Maynor..... Training Officer, Robeson County EMS
Tammy DeeseMaxton Rescue Squad
Roger “Bo” Morgan.....Pembroke City Fire Department
Kenny Locklear.....Director of EMS Education, Robeson CC
Eric FreemanVice President, Continuing Education, Robeson CC
Daniel Ivey.....Lumberton Rescue & EMS
Chris WestChief, Lumberton Fire Department
Robert Ivey.....Director, Fire & Rescue Training, Robeson CC
Timmy Ivey.....Orrum Fire Department
Randy Locklear.....Prospect Fire Department, **COMMITTEE VICE PRESIDENT**
Bob Sechler.....Lumber Bridge Fire Department
Bruce Meares Lumberton Rescue & EMS, **COMMITTEE TREASURER**
Betty Meekins..... Red Springs Rescue Squad
Harvey Inman.....President, Robeson County Fireman’s Association
Darell SnowCommander, Red Springs Rescue Squad
Terry VanderhallRowland Rescue Squad, **COMMITTEE PRESIDENT**



Thank you to the Lumberton Visitors Bureau for their
continued support of our seminar!

AREA HOTELS

Please mention you are attending the Southeast Fire/Rescue College

**SpringHill Suites
Exit 22, I-95
(910) 738-2085**

**SpringHill is our host hotel accommodating instructors.
A block of rooms is reserved for students. Early reservations are recommended.**

Holiday Inn
Exit 22, I-95
(910) 671-1166

Comfort Inn
Exit 20, I-95
(910) 345-0260

Quality Inn
Exit 22, I-95
(910) 674-4473

Comfort Suites
Exit 22, I-95
(910) 739-8800

Fairfield Inn
Exit 20, I-95
(910) 739-8444

Country Inn & Suites
Exit 20, I-95
(910) 738-3838

Quality Inn
Exit 22, I-95
(910) 674-4473

Best Western
Exit 22, I-95
(910) 618-9799

Hampton Inn
Exit 22, I-95
(910) 738-3332



2022 Vendors

Air Life NC
AEST Safety
Atlantic Emergency Solutions
Coastal Fire Equipment
Code 3 Insurance
East Coast Fire Apparatus
Graham Battery
Greenstate Pools
Civic Credit Union/LGFCU
NAFECO
Robeson County Sheriff's Office
Select Custom Apparatus
Wally's Fire and Safety
Lumberton Fire Department
Lumberton Firefighters Association
Locklear Tactical
Lumberton Rescue & EMS
Ashpole Knives
Custom Truck
NCOSFM
Cape Fear Valley Life Link

Thank you for supporting the Southeast Fire Rescue College!

2023 SOUTHEAST FIRE/RESCUE COLLEGE

Mail \$35 check PAYABLE TO RCC **OR**
Fax, Email or call to make credit card payment
- No CC # by phone -
DANIELLE BURNETTE (910) 272-3330
PO BOX 1404 **sburnette@robeson.edu**
LUMBERTON, NC 28359 (910) 272-3325 fax

SS# _____ - _____ - _____ My T-Shirt Size _____
DOB ____/____/____
Email _____

Name: _____
Last First MI

Address: _____
Street/PO Box City State Zip

County of Residence: _____ Phone: _____

Race: ☐ White ☐ Black ☐ American/Alaska ☐ Hispanic ☐ Asian ☐ Other Ethnicity: ☐ Hispanic/Latino
Sex: ☐ Male ☐ Female ☐ Non Hispanic/Latino

Highest Grade Completed: 0 1 2 3 4 5 6 7 8 9 10 11 12 AHS GED
☐ One Year Vocational ☐ Associate Degree ☐ Bachelor's Degree ☐ Master's Degree or Higher

Employment: ☐ Full Time ☐ Part Time ☐ Retired ☐ Unemployed

Type of Agency/Department: ☐ VOLUNTEER Fire Dept ☐ PAID Fire Dept ☐ PAID Law Enforcement Agency
☐ Non-Profit VOLUNTEER EMS or Rescue & Lifesaving Dept ☐ Non-Profit PAID EMS or Rescue & Lifesaving Dept

Name of Agency/Department: _____

Job Title with Agency/Dept: ☐ Police Officer or Deputy ☐ Auxiliary Police Officer ☐ Firefighter ☐ Paramedic
☐ EMT ☐ Rescue ☐ Other _____

***STUDENT'S SIGNATURE:** _____

*MY SIGNATURE AUTHORIZES ROBESON COMMUNITY COLLEGE TO TAKE & UTILIZE PHOTOS OR VIDEO OF ME OR MY PROPERTY FOR PURPOSES OF PROMOTING, MARKETING, & ADVERTISING THE COLLEGE. I UNDERSTAND & AGREE THAT PHOTOS OR LIKENESSES OF ME OR MY PROPERTY MAY APPEAR IN PRINT, ON TELEVISION, OR ON THE WEB, & THAT I WILL RECEIVE NO COMPENSATION. *MY SIGNATURE AUTHORIZES RCC TO RELEASE (WHEN REQUIRED) A REPORT INDICATING THAT I HAVE SUCCESSFULLY COMPLETED ALL REQUIREMENTS (ATTENDANCE, WRITTEN, & PRACTICAL TESTS) FOR CERTIFICATION. *ADMISSION TO ANY & ALL EDUCATIONAL PROGRAMS OFFERED BY RCC I MADE WITHOUT REGARD TO RACE, COLOR, SEX, RELIGION, AGE, DISABILITY, OR NATIONAL ORIGIN. FOR TITLE IX QUESTIONS, CALL 910-272-3505.

*****LIST CLASS NUMBERS ONLY***** (Students will be emailed by January 28th if 1st choice is unavailable.)

1st Choice: _____ 2nd Choice: _____ 3rd Choice: _____ 4th Choice: _____

CREDIT CARD INFORMATION

Note: If paying by credit card, information must be provided below.

____ MasterCard ____ Visa

Card # _____ Exp. Date _____ 3-digit code _____

Card Holder's Name _____ Authorized Signature _____

Total Amount \$ _____ Payment Date _____ Phone _____

Student name

Department

Name of Training Officer or Chief completing this form

The 2018 edition of NFPA Standard 1403 requires that: "Students participating in live fire training evolution who have received the required minimum training and prerequisites from other than the authority having jurisdiction shall not be permitted to participate in any live fire training evolution without presenting prior written evidence of having successfully completed the prescribed minimum training to the levels specified in 4.3.1 (required minimum training) and 4.3.2.1 through 4.3.2.5 (prerequisites)." These required minimum training subjects (4.3.1) and prerequisites (4.3.2) are:

- | | | | |
|--|-------|--|-------|
| 1. 4.3.1 - Safety | _____ | 9. 4.3.1 - Ventilation | _____ |
| 2. 4.3.1 - Fire Behavior | _____ | 10. 4.3.1 - Forcible Entry | _____ |
| 3. 4.3.1 - Portable Extinguishers | _____ | 11. 4.3.1 - Building Construction | _____ |
| 4. 4.3.1 - Personal Protective Equipment | _____ | 12. 4.3.2.1 - Fire Dynamics | _____ |
| 5. 4.3.1 - Ladders | _____ | 13. 4.3.2.2 - Health and Safety | _____ |
| 6. 4.3.1 - Fire Hose, Appliance, and Streams | _____ | 14. 4.3.2.3 - Fundamentals of Fire Behavior | _____ |
| 7. 4.3.1 - Overhaul | _____ | 15. 4.3.2.4 - Fire Development in a Compartment | _____ |
| 8. 4.3.1 - Water Supply | _____ | 16. 4.3.2.5 - Nozzle Techniques and Door Control | _____ |

The Fire Chief or Training Officer of _____ Department authorizes that _____ has completed the required minimum training and prerequisites and may participate in the live fire training evolutions delivered by any NCFRC approved Delivery Agency and/or led by any NCFRC qualified live fire instructor.

Student, or participant, shall be at least 18 years of age to participate in live fire delivered by any NCFRC approved Delivery Agency and/or led by any qualified live fire instructor. ID's will be checked by qualified instructors before allowing students to participate in the live fire training. Signatures below validates that the student is at least 18 years old and have successfully completed the above required minimum training and prerequisites.

Chief or Training Officer Signature**Date**

Instructor Signature**Date**

Student Signature**Date**

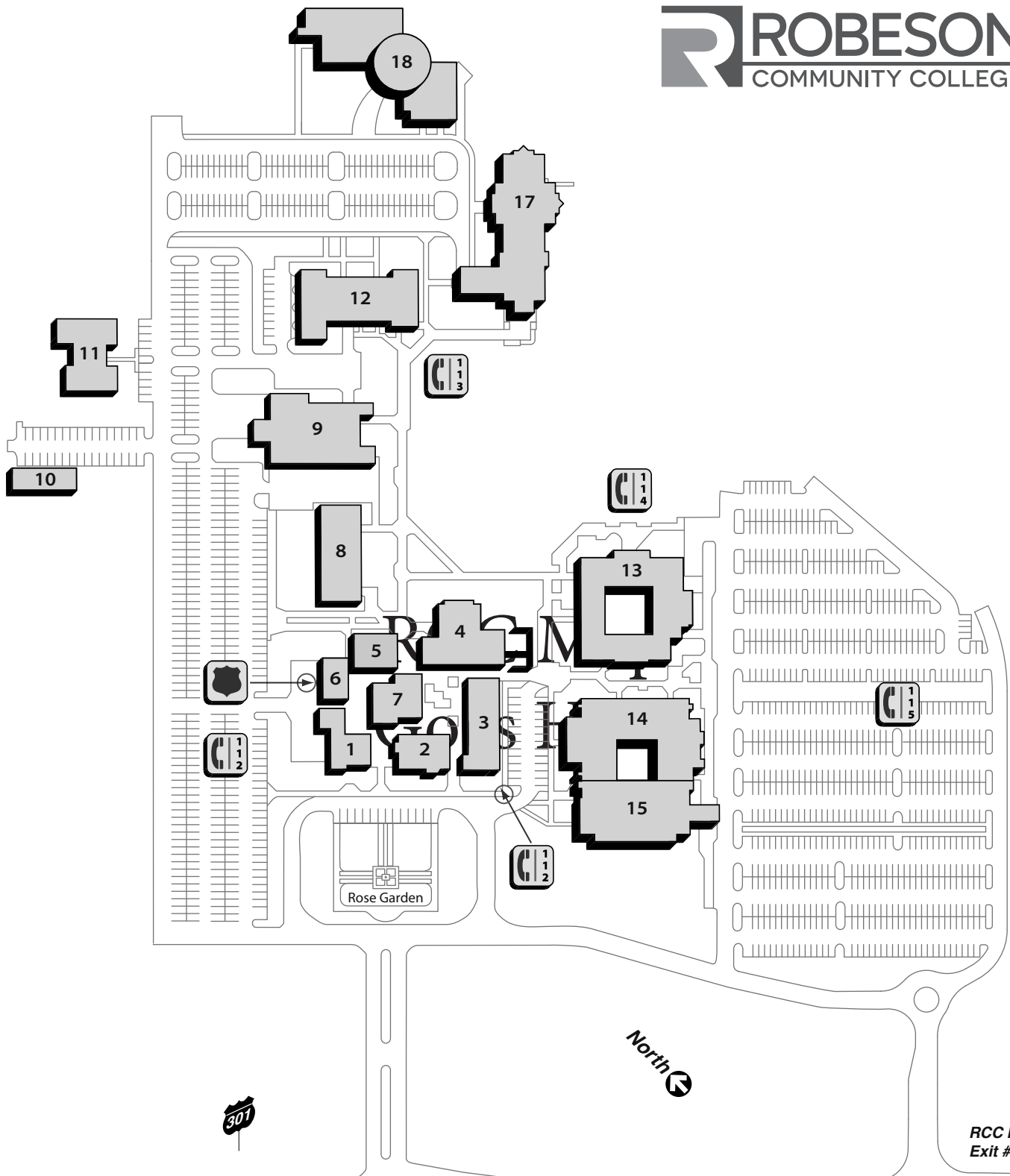

← St. Pauls

Lumberton & Interstate 95 →



Handicapped parking spaces in all lots



Callbox



Campus Police



Visitor parking located in front of buildings 1 & 2, between buildings 3 & 14, in front of building 17

Dawn Drive

Notes

[illegible]

Notes

Photos from 48th Annual Southeast Fire/Rescue College



For more information, call 910-272-3330
or visit our website at www.robeson.edu/fireedu



3,000 copies of this book were printed at a cost of \$1.06 per copy.

Robeson Community College is an Equal Opportunity Institution

2024 Southeast Fire/Rescue College
February 7, 8, 9, 10 & 11