

48th Southeast

FIRE/RESCUE COLLEGE LAW ENFORCEMENT EXPO

February 9-13, 2022

www.robeson.edu/fireedu



Robeson Community College

Lumberton, North Carolina



In Loving Memory



Datry Hunt
1944 - 2020
Raynham F.D.



Tammy Black
1969 - 2020
White Lake F.D.



Willie Chavis
1942 - 2020
Rowland Rural F.D.



MJ Hunt 2020-2021
(son of Jamie Bell)
Robeson County EMS



Serena Locklear
2002 - 2021
Red Springs F.D.



Mike Overton
1968 - 2021
Big Marsh F.D.



Georgette Callahan
1959 - 2021
Robeson County 911



Timmy Wilkins
1968 - 2021
Lumberton P.D.



Milton Morgan
1959 - 2021
Lumberton Rescue

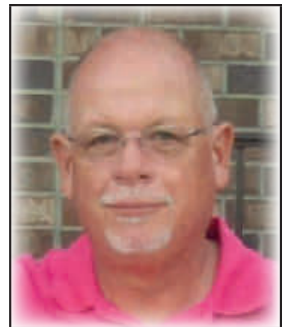

Randal Patterson
1955 - 2021
Lumberton Rescue

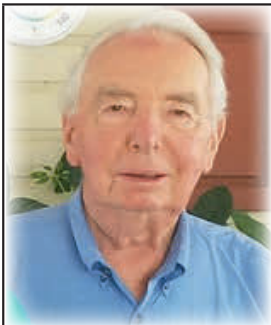

Hal Ivey
1935 - 2021
Orrum F.D.



Maurice Britt
1929 - 2021
Lumberton F.D.



Earl Hoffman
1952 - 2021
Lumberton P.D.



Woody Huggins
1931 - 2021
Lumberton City Council



Dwayne Locklear
1963 - 2021
Pembroke Rural F.D.



Kenny Britt
1956 - 2021
Northwoods F.D.



Jennifer Stephens
1977 - 2021
Orrum F.D.



Donna Cagle
1972 - 2021
Bladen County EMS



John Jackson
1943 - 2021
Fairmont City F.D.

*Thank you for
your service.*



DEDICATION



Susan Kinlaw Bryan
1961 - 2021

The 2022 Southeast Fire Rescue and Law Enforcement planning Committee dedicates this year's seminar to Mrs. Susan K. Bryan, who passed away in 2021.

Susan was a honorary member with Lumberton Rescue and EMS, after serving as an active member for twenty years. She truly had a servant's heart, helping others through both rescue and her church,

We recognize Susan's contributions to the first responder community and thank her for her service.

- Planning Committee Members

REGISTRATION INFORMATION

\$35 for NC Emergency Services Personnel – all classes

Out of state/non-affiliated students must pay an additional fee. See below:

\$100 for classes 24 hours or less.

\$155 for classes over 24 hours.

Registrations can be mailed, emailed or faxed with credit card information, which is located at the bottom of the registration form. Payment is required when submitting registrations! If mailing, use Post Office Box 1404, Lumberton, NC, 28359.

When completing the registration form, use the class number to indicate your choice of classes. You can pick up to four choices.

Class Check-in: Room assignments will be posted at the registration desk in building 13, the student center. All classes, with the exception of a few, will be held on main campus. You must be present the first day of class in order to register. Please be on time.

Certificates: The college does not issue attendance certificates. Certification class grades will be submitted to NC OSFM and should show on your transcript within 30 days of course completion. Students who fail a course will be notified by letter.

Emergencies: During class hours, dial (910) 272-3338.

Refunds will not be given for **any** reason. If you cannot attend, another student may attend in your place provided you call ahead and notify us of the change at (910) 272-3330.

Class cancellations will be made **January 21**. If you do not receive your first choice, you will be notified of your new class assignment. **Clearly** write your email address on your registration form, as well as a contact telephone number.

Robeson Community College mandates masks be worn while inside classrooms and buildings due to COVID-19 protocol. Please wear your mask, social distance and wash your hands.

Smoking and the use of tobacco products are prohibited on any RCC Campus.

Questions? Call 910-272-3330 or 910 272-3329.

SCHEDULE OF CLASSES

Wednesday February 9, 2022

1pm	TR Machinery and Ag Rescue (ESTC)
1pm	FF Ops 5 (ESTC)
1pm	FF Ops 9 (ESTC)
1pm	Hazardous Materials Operations (Main Campus)
1pm	Fire Officer 1 (Main Campus)
1pm	Driver Operator Pumps Introduction/Basic Operations (Main Campus)
1pm	Driver Operator Pumps Water Supplies (Main Campus)
1pm	NIMS 300 (Main Campus)

Thursday February 10, 2022

1pm	Rescue Diver (Main Campus)
1pm	FF Ops 3 (Main Campus)
1pm	FF Ops 4 (Main Campus)
1pm	Fire Officer II (Main Campus)
1pm	Mobile Water Supplies (Main Campus)
1pm	Driver Operator Sprinklers and Standpipes/Testing (Main Campus)

Friday February 11, 2022

1pm	Additional classes begin (Main Campus)
6pm	Remaining classes begin (Main Campus)
6pm-10pm	Vendors - Fred G. Williams Student Center-Bldg. 13

Saturday February 12, 2022

8am-6pm	Vendors – Fred G. Williams Student Center-Bldg. 13
8am-830am	Classes begin (Main Campus)
1130am-1pm	Lunch on your own (Please patronize area restaurants)

Sunday February 13, 2022

730am-8am	Devotion – Building 18 (BB&T Room)
8am-12pm	Vendors - Fred G. Williams Student Center-Bldg. 13
8am	Classes begin

CHECK REGISTRATION DESK IN BUILDING 13 FOR ROOM ASSIGNMENTS

SPECIALTY NON-CERTIFICATION

1. Not Your Everyday Pin Job
2. Fireground Survival
3. De-Escalation and Driver Simulator Training

FIREFIGHTER CERTIFICATION

4. FF General and Communications
5. FF Fireground Ops 1
6. FF Fireground Ops 2
7. FF Fireground Ops 3
8. FF Fireground Ops 4
9. FF Fireground Ops 5
10. FF Fireground Ops 6
11. FF Fireground Ops 7
12. FF Fireground Ops 8
13. FF Fireground Ops 9
14. FF Rescue Ops 1
15. FF Fire and Life Safety Initiatives
16. Mayday/Safety and Survival
17. FF/TR Emergency Medical Care

TECHNICAL RESCUER CERTIFICATION

18. TR Rope Basics
19. TR Rescue Operations
20. TR Victim Management
21. TR Machine and Agricultural Rescue

DRIVER/OPERATOR CERTIFICATION

22. Driver Operator Pumps Introduction/Basic Operations
23. Emergency Vehicle Driver
24. Driver Operator Hydraulics/Water Supplies
25. Driver Operator Sprinklers/Maintenance and Testing
26. Mobile Water Supply

HAZMAT CERTIFICATION

27. Hazardous Materials Operations

NIMS

28. NIMS 300
29. NIMS 400

SPECIALTY CERTIFICATION

30. Chief 101
31. Chief 101 Refresher
32. Fire Officer I
33. Fire Officer II

CODE ENFORCEMENT CERTIFICATION

- 34. Law & Administration

EMS

- 35. American Heart Association CPR Instructor Course

NATIONAL FIRE ACADEMY

- 36. Initial Fire Investigations for First Responders
- 37. Leadership in Supervision: Creating Environments for Personal Growth
- 38. Leadership in Supervision: Perspectives in Thinking

NON-CERTIFICATION

- 39. Explosives, Bombs & Booby Traps
- 40. Fatal Fire Investigations
- 41. Advanced Fire Firefighting
- 42. NFPA 1403 Academy
- 43. Land Navigation
- 44. NC Rating Response System
- 45. Rescue Diver

NOTICE TO STUDENTS

Effective July 1, 2019, all students participating in live fire training are required to be eighteen years of age and have met the minimum requirements for NFPA 1403. The chief or training officer of the department will be required to sign off on students who have met the minimum requirements before they can participate. A copy of the required form is located on the back of the registration form.

All students attending classes for certification through the NC Office of State Fire Marshal are required to have proper identification with them, as verification is required before being administered a certification test.

Any questions or concerns, please call the training center at 910-272-3330.



SPECIALTY NON-CERTIFICATION

1. Not Your Everyday Pin Job (18 hours)

Friday 630pm-830pm, Saturday 8am-5pm & Sunday 8am-5pm

This class will consist of real-world tactics which are used to free patients from major pin jobs. Hands on training dealing with side resting vehicles, vehicles with major intrusions, vehicle overrides and dash displacement, to include techniques for dash evolutions on pin jobs. **(PPE Required)**

Instructor: Toranze "Toot" Lee with Premier Extrication

2. Fireground Survival (16 hours)

Saturday 8am-5pm & Sunday 8am-5pm

This class is totally hands on and will encompass training on forcible entry, wall breeches, below grade firefighter retrieval, Denver drill, victim removal and downed firefighter CPR. **(PPE Required)**

Instructors: Box 1971 LLC

3. De-Escalation/Driving Simulator Training (4 hours)

Saturday 8am-12pm and 1pm-5pm (Two separate sessions, register only for one and specify AM/PM)

Being a first responder puts you in situations that could become potentially dangerous. This training is designed to give first responders hands on reality-based training. Also included is driver simulation training using RCC's new state of the art firearms and driving simulator, which includes police vehicles, fire trucks and ambulance scenarios.

FIREFIGHTER 2019 CERTIFICATION

Students must provide appropriate personal protective equipment for all classes.

4. FF General and Communications (24 hours)

Friday 1pm-10pm, Saturday 8am-6pm & Sunday 8am-4pm

This block of instruction covers orientation and fire service communications.

5. FF Fireground Ops 1 (24 hours)

Friday 1pm-10pm., Saturday 8am-6pm & Sunday 8am-4pm

This block of instruction covers firefighter health and safety.

6. FF Fireground Ops 2 (24 hours)

Friday 1pm-10pm, Saturday 8am-6pm & Sunday 8a-4pm

This block of instruction covers firefighter personal protective equipment.

7. FF Fireground Ops 3 (32 hours)

Thursday 1pm-10pm, Friday 8am-6pm, Saturday 8am-6p, & Sunday 8am-3pm

This block of instruction covers building construction, portable extinguishers and fire behavior.

8. FF Fireground Ops 4 (32 hours)

Thursday 1pm-10pm, Friday 8am-6pm, Saturday 8am-6p, & Sunday 8am-3pm

This block of instruction covers tools, forcible entry and loss control.

9. FF Fireground Ops 5 (40 hours) Report directly to the training center

Wednesday 1pm-10pm, Thursday 8am-6pm, Friday 8am-6pm, Saturday 8am-6pm & Sunday 8am-2pm

This block of instruction covers ladders and ventilation.

10. FF Fireground Ops 6 (24 hours)

Friday 1pm-10pm, Saturday 8am-6pm & Sunday 8am-4pm

This block of instruction covers ropes, knots and search and rescue.

11. FF Fireground Ops 7 (24 hours)

Friday 1pm-10pm, Saturday 8am-6pm & Sunday 8am-4pm

This block of instruction covers water supplies.

12. FF Fireground Ops 8 (24 hours)

Friday 1pm-10pm, Saturday 8am-6pm & Sunday 8am-4pm

This block of instruction covers fire hose, streams and appliances,

13. FF Fireground Ops 9 (40 hours) Report directly to the training center

Wednesday 1pm-10pm, Thursday 8am-6pm, Friday 8am-6pm, Saturday 8am-6pm & Sunday 8am-2pm

This block of instruction covers fire control. All students are required to bring a signed live fire course competency validation form with them on the first day of class.

14. FF Rescue Ops 1 (24 hours)

Friday 1pm-10pm, Saturday 8am-6pm & Sunday 8am-4pm

This block of instruction covers rescue in the fire service.

15. FF Fire and Life Safety Initiatives (24 hours)

Friday 1pm-10pm, Saturday 8am-6pm & Sunday 8am-4pm

This block of instruction covers detection and suppression systems and fire & life safety initiatives.

16. Mayday and Safety and Survival (24 hours)

Friday 1pm-10pm, Saturday 8am-6pm & Sunday 8am-4pm

17. FF/TR Emergency Medical Care (12 hours)

Friday 630pm-1030pm & Saturday 8a-5pm

This block of instruction covers first aid, CPR and AED.



TECHNICAL RESCUER CERTIFICATION

Students must provide appropriate personal protective equipment for all classes.

18. TR RESCUE OPERATIONS (14 hours)

Friday 7pm-10pm., Saturday 8am-4pm & Sunday 8am-12pm

This course will present the Technical Rescuer (TR) with the requirements for pre-planning, scene size-up, and hazards assessment for incidents involving rope rescue. This course will also introduce the Technical Rescuer to applicable standards addressing rope rescue, Personal Protective Equipment (PPE), accessory gear, rope software, and rope hardware. NFPA 1006 Chapters 5 and 6.

19. TR ROPE BASICS (14 hours)

Friday 7pm-10pm., Saturday 8am-4pm & Sunday 8am-12pm

This course will present to the Technical Rescuer (TR) safe and effective methods of rescue in elevated and below grade environments using ropes, knots, and rope related equipment. Mechanical advantage, anchors, anchoring techniques, and stress loads will be covered. NFPA 1006 Chapters 5 and 6.

20. TR VICTIM MANAGEMENT (16 Hours)

Friday 630pm-1030pm, Saturday 830am-530pm & Sunday 8am-12pm

The course will present to the Technical Rescuer (TR) the safe and effective methods of rescuing a victim using multiple scenarios. NFPA 1006 Chapters 5 and 6.

21. TR MAG MACHINERY AND AG BLOCK (40 hours)

Wednesday 1pm-10pm, Thursday 8am-6pm, Friday 8a-6pm, Saturday 8am-6pm & Sunday 8am-1pm

REPORT DIRECTLY TO THE EMERGENCY SERVICES TRAINING CENTER

***** Class is limited to 30 students*****

This block course will present the Technical Rescuer with the knowledge, skills, and abilities to satisfy the requirements of Chapter 19 (Machinery) of NFPA 1006: Standard for Technical Rescue Professional Qualifications. In addition, this course covers agricultural-related emergencies and how to mitigate those responses.

NOTE: A NC FIRE AND RESCUE COMMISSION CERTIFICATION FOR THIS CLASS WILL ONLY BE GIVEN TO THE STUDENT WHO CURRENTLY HOLDS A TR VEHICLE AND TR ROPES CERTIFICATION.



Like and follow us on Facebook!

Robeson Community College Emergency Services Training Center

DRIVER/OPERATOR CERTIFICATION

Students must provide appropriate personal protective equipment for all classes.

22. PUMPS INTRODUCTION AND BASIC OPERATIONS (36 Hours)

Wednesday 1pm-10pm, Thursday 8am-5pm, Friday 8am-5p, Saturday 8am-5p & Sunday 8am-12pm

23. EMERGENCY VEHICLE DRIVER (24 hours)

Friday 1pm-10pm, Saturday 8am-6pm & Sunday 8am-4pm

Pre-requisite: A copy of your valid driver's license must be given to instructor in class

24. PUMPS HYDRAULICS AND WATER SUPPLY (36 hours)

Wednesday 1pm-10pm, Thursday 8am-5pm, Friday 8am-5p, Saturday 8am-5p & Sunday 8am-12pm

25. PUMPS SPRINKERS, STANDPIPES AND MAINTENANCE AND TESTING (28 Hours)

Thursday 1pm-10pm, Friday 8am-5pm, Saturday 8am-5p & Sunday 8am-12pm

26. MOBILE WATER SUPPLY (28 Hours)

Thursday 1pm-10pm, Friday 8am-5pm, Saturday 8am-5p & Sunday 8am-12pm



HAZMAT CERTIFICATION

27. HAZARDOUS MATERIALS OPERATIONS (40 Hours)

Wednesday 1pm-10pm, Thursday 8am-6pm, Friday 8a-6pm, Saturday 8am-6pm & Sunday 8am-1pm

This course meets OSFM's training requirements for the Hazardous Materials Operations credential. Course content includes lecture and practice activities needed to perform the following tasks safely and effectively: (1) implement standard operating procedures in the current edition of the DOT Emergency Response Guidebook; (2) analyze hazardous materials/WMD incident; (3) plan an initial response to a hazardous materials/WMD incident; (4) implement the planned response for a hazardous materials/WMD incident; (5) evaluate the progress of the actions taken at a hazardous materials/WMD incident.

Needs: Full PPE

NIMS

You must register with NC Emergency Management TERMS @ <http://terms.ncem.org/TRS/> to receive your NC Emergency Management certificate.

28. NIMS 300 (20 hours)

Wednesday 1pm-10pm, Thursday 830am-530pm & Friday 830am-1230pm

This course is for persons at mid-level management serving as command staff, section chiefs, strike team leaders, task force leaders, unit leaders, division/group supervisors, branch directors, and multi-agency coordination system/emergency operations center staff.

29. NIMS 400 (12 hours)

Saturday 830am-530pm & Sunday 830am-1230pm

This advanced Incident Command System (ICS) course is designed to explain how major incidents engender special management challenges, describe the circumstances in which an Area Command is established, and describe the circumstances in which multi-agency coordination systems are established.



Scan our QR code to find classes scheduled all year!

SPECIALTY CERTIFICATION

30. CHIEF 101 (8 hours)

Saturday 830am – 530pm

This class will satisfy the 9S inspection criteria as specified by the North Carolina Administrative Code. The primary objective of the course is to inform current and future chief officers of the various aspects and complexities surrounding the operations and organization of North Carolina fire departments. Emphasis will be placed on ratings and inspections, NFIRS reporting, prevention and grant programs, basic line-of-duty death information, financial considerations, and an overview of the various expectations facing a chief officer.

31. CHIEF 101 REFRESHER (4 hours)

Friday 600pm-10pm

Refresher course for those who have already taken the full 8-hour course.

32. FIRE OFFICER I (40 hours)

Wednesday 1pm-10pm, Thursday 8am-6pm, Friday 8a-6pm, Saturday 8am–6pm & Sunday 8am–1pm

This course identifies the performance requirements necessary to perform the duties of a first line supervisor. This course introduces the student to the basic concept of management and supervision. Upon completion, the individual will be able to supervise, instruct, and direct members of the fire department in both emergency and non-emergency situations.

Needs: Jones & Bartlett "Fire Officer Principals & Practices" 3rd edition.

33. FIRE OFFICER II (32 hours)

Thursday 1pm-10pm, Friday 8a-6pm, Saturday 8am–6pm & Sunday 8am–3pm

This course will present the knowledge, skills and ability to satisfy the requirements of the Chapter V of the NFPA 1021: Standard for Fire Officer Professional Qualifications. This course is designed to meet the needs of the mid-level officer/supervisor.

Needs: Jones & Bartlett "Fire Officer Principals & Practices" 3rd edition.

CODE ENFORCEMENT CERTIFICATION

34. LAW & ADMINISTRATION (15 hours)

Friday 7pm-10pm., Saturday 830am-5pm & Sunday 8am-1pm

This course is designed to provide a basic understanding of the governmental and legal system with which every code enforcement official works. The course satisfies the training requirements to gain admission to the state qualifying exam. Students are to furnish their own textbook "Administration Code and Policies" of the North Carolina State Building Code, latest edition.

EMS

35. AMERICAN HEART ASSOCIATION CPR INSTRUCTOR COURSE (16 Hours)

Saturday 8a-5p and Sunday 8am-5pm

The BLS Essentials Course is designed to prepare instructor candidates on how to teach AHA courses. Students are required to have a current AHA CPR Provider card. No other cards will be accepted. Students will also be required to have a copy of the current AHA Instructor Manual. A manual may be purchased at <http://shopcpr.heart.org/courses/bls>. Students must successfully pass a 25-question examination, making 84% or higher. Additional requirements will be discussed in class. Any questions, contact Brad Lawson at blawson@robeson.edu.



NATIONAL FIRE ACADEMY

A National Fire Academy SID (Student Identification) number is required for any NFA class. You must have your SID number with you if you plan to attend any of the following classes. Please obtain your SID number at <http://www.usfa.fema.gov/nfa/about/attend/ftin.shtm>

36. INITIAL FIRE INVESTIGATIONS FOR FIRST RESPONDERS (16 hours)

Friday 6pm-10pm, Saturday 8am-5pm & Sunday 8am-12pm

This course provides a clear definition of the role of initial responder to recognize the potential of an intentionally set fire, preserve evidence, and properly report the information to appropriate officials. Basic topics include: fire behavior, critical observations of the first responder, fire cause, scene security and evidence preservation, legal considerations, and the reporting of findings.

37. LEADERSHIP IN SUPERVISION: CREATING ENVIRONMENTS FOR PROFESSIONAL GROWTH (16 hours)

Friday 6pm-10pm, Saturday 8am-5pm & Sunday 8am-12pm

This course presents the supervisor with the basic leadership skills and tools needed to perform effectively in the fire service environment and includes concepts related to a successful transition to supervisory and leadership roles, including concepts of adaptive leadership; change management; active followership; effective communication, including difficult conversations and advocacy-inquiry-based dialogue; ethics; authority; power; decision making; and active engagement through development of a personal plan.

38. LEADERSHIP IN SUPERVISION: PERSPECTIVES IN THINKING (16 hours)

Friday 6pm-10pm, Saturday 8am-5pm & Sunday 8am-12pm

This course provides the supervisor with the conceptual foundation and framework for success in leadership roles by exploring creative, analytical, political and critical thinking perspectives and addresses skills needed for assessing situations from multiple perspectives, making critical decisions, fostering creativity and innovation, and using persuasion.





NON-CERTIFICATION

39. EXPLOSIVES, BOMBS & BOOBY TRAPS (15 hours)

Friday 7pm-10pm., Saturday 830am – 500pm & Sunday 800am-1pm

This class takes Emergency First Responders (EMS, Fire, Law Enforcement, and Rescue) through basic understandings of explosives, explosive environments and understanding how they function. The latest Improvised Explosive Devices (IEDs) being employed overseas and domestically, how they are constructed, the damage they can cause, and how they are being used by terrorists against first responders. Also, what first responders can do to ensure their safety against this new threat. The course will take the students through bomb threats, searches, and booby traps, all of which they may encounter in their jobs. It will also discuss ways to discover terrorist methods, activities and the latest cases and ways they can help stop future events in the U. S. This course will be presented through classroom instruction and practical exercises including bomb searches, booby trapped trails, and live explosive demonstrations.

40. FATAL FIRE INVESTIGATIONS (12 hours)

Saturday 830am – 500pm & Sunday 800am – 1pm

This course aids in all parts of fire and law enforcement investigations into any type of fatal fire and will go over many avenues of responsibility of each party and will help everyone with the scene and follow up.

41. ADVANCED FIREFIGHTING TECHNIQUES (20 Hours)

Friday 1pm-10pm, Saturday 8am-5pm & Sunday 8am-12pm

Minimum age requirement is 18 years old. Full PPE with SCBA is required.

This course is designed for the experienced firefighter to practice suppression techniques in a variety of live fire scenarios. Instructors will incorporate the use of LP gas props, rail car, burn trailer and class A burn building. **NC OSFM Live Fire Course Competency Validation Form 200.14a (on the back of the registration form) MUST be completed in order to enroll!**

42. NFPA 1403 ACADEMY (22 Hours)

Friday 1pm-10pm, Saturday 8am-6pm & Sunday 8am-1pm

This course is designed for the firefighter with little or no experience. Basics to be covered include fire streams, SCBA, hose practices, building construction, ladders and fire behavior. Practical applications will be used. This class meets the minimum qualifications for NFPA 1403.

Needs: Full PPE

43. LAND NAVIGATION (20 hours)

Friday 6-10 p.m., Saturday 8 a.m. – 7 p.m., & Sunday 8 a.m. – 2 p.m.

This class will consist of the use of GPS and compass over terrain and how to determine your location while on a mission. There will be practical exercises for the student to become familiar with both of these tools for search activities.

Needs: Compass

44. NC RATING RESPONSE SYSTEM (12 hours)

Saturday 830am – 500pm & Sunday 800am-1pm

A representative from the NC Department of Insurance will discuss the new rating response system program and how it relates to the ISO system. Learn how your department will be rated in the future.

Needs: Calculator, paper, No. 2 pencils, map of your service area with all hydrants, and apparatus inventories on all trucks in your department.

45. RESCUE DIVER (22 Hours)

Friday 6pm-10pm, Saturday 8am-9pm & Sunday 8am-3pm

The rescue diver certification is designed to develop the knowledge and necessary skills for an individual to effectively perform diver rescues and assists, and administer necessary first aid.

Note: Class will meet on main campus Friday evening and be at off site locations Saturday and Sunday.



ROBESON COUNTY BOARD OF COMMISSIONERS



Faline Dial, Chairman
Pauline Campbell
David Edge
Lance Herndon
Wixie Stephens
Judy Sampson
John Cummings
Tom Taylor



Kelli Blue, **County Manager**

Thank you for your continued support of



A special thank you also to Chris Ivey and Tasha Hunt Ivey for help in designing this year's brochure!

SOUTHEAST FIRE/RESCUE COLLEGE PLANNING COMMITTEE

Danielle Burnette.....Qualified Assistant, RCC Fire & Rescue Training
Randy Carlyle.....President, Robeson County Rescue Association
Mattie CaulderAssistant Director, Robeson County Emergency Management
Stephanie ChavisRobeson County Fire Marshal & Director, Robeson County Emergency Management
Patrick CummingsDirector, Robeson County EMS
Tammy Deese.....Maxton Rescue Squad
Buddy Dial Evans Crossroads Fire Department
Kenny Locklear.....Director of EMS Education, Robeson CC
Steven C. Hunt.....Vice President, Continuing Education, Robeson CC
Daniel Ivey.....Lumberton Rescue & EMS
Chris West.....Interim Chief, Lumberton Fire Department
Robert Ivey.....Director, Fire & Rescue Training, Robeson CC
Timmy Ivey.....Orrum Fire Department
Randy Locklear.....Prospect Fire Department, **COMMITTEE VICE PRESIDENT**
Leo McMillan.....Shannon Fire Department
Bruce MearesLumberton Rescue & EMS, **COMMITTEE TREASURER**
Betty Meekins..... Red Springs Rescue Squad
Landon Moore.....President, Robeson County Fireman's Association
Darell SnowCommander, Red Springs Rescue Squad
Terry VanderhallRowland Rescue Squad, **COMMITTEE PRESIDENT**
Jerry WaggonerSmyrna Fire Department
Walter Lee Hinson.....Director, Law Enforcement Continuing Education, Robeson CC
Eric Freeman.....Assistant Vice President Workforce Development Robeson CC



*Thank you to the Lumberton Visitors Bureau for their
continued support of our seminar!*

AREA HOTELS

Please mention you are attending the Southeast Fire/Rescue College

SpringHill Suites Exit 22, I-95 (910) 738-2085

**SpringHill is our host hotel accommodating instructors.
A block of rooms is reserved for students. Early reservations are recommended.**

Holiday Inn

Exit 22, I-95
(910) 671-1166

Comfort Inn

Exit 20, I-95
(910) 345-0260

Quality Inn

Exit 22, I-95
(910) 674-4473

Comfort Suites

Exit 22, I-95
(910) 739-8800

Fairfield Inn

Exit 20, I-95
(910) 739-8444

Country Inn & Suites

Exit 20, I-95
(910) 738-3838

Quality Inn

Exit 22, I-95
(910) 674-4473

Best Western

Exit 22, I-95
(910) 618-9799

Hampton Inn

Exit 22, I-95
(910) 738-3332



2022 SOUTHEAST FIRE/RESCUE COLLEGE & LAW ENFORCEMENT EXPO

Mail \$35 check PAYABLE TO RCC **OR**

Fax, Email or call to make credit card payment

DANIELLE BURNETTE (910) 272-3330

PO BOX 1404 **sburnette@robeson.edu**

LUMBERTON, NC 28359 (910) 272-3325 fax

SS# _____ - _____ - _____

My T-Shirt Size _____

DOB ____/____/____

Email _____

Name: _____

Last

First

MI

Address: _____

Street/PO Box

City

State

Zip

County of Residence: _____ Phone: _____

Race: ☐ White ☐ Black ☐ American/Alaska ☐ Hispanic ☐ Asian ☐ Other

Ethnicity: ☐ Hispanic/Latino

Sex: ☐ Male ☐ Female

☐ Non Hispanic/Latino

Highest Grade Completed: 0 1 2 3 4 5 6 7 8 9 10 11 12 AHS GED

☐ One Year Vocational ☐ Associate Degree ☐ Bachelor's Degree ☐ Master's Degree or Higher

Employment: ☐ Full Time ☐ Part Time ☐ Retired ☐ Unemployed

Type of Agency/Department: ☐ VOLUNTEER Fire Dept ☐ PAID Fire Dept ☐ PAID Law Enforcement Agency

☐ Non-Profit VOLUNTEER EMS or Rescue & Lifesaving Dept ☐ Non-Profit PAID EMS or Rescue & Lifesaving Dept

Name of Agency/Department: _____

Job Title with Agency/Dept: ☐ Police Officer or Deputy ☐ Auxiliary Police Officer ☐ Firefighter ☐ Paramedic

☐ EMT ☐ Rescue ☐ Other _____

*STUDENT'S SIGNATURE: _____

*MY SIGNATURE AUTHORIZES ROBESON COMMUNITY COLLEGE TO TAKE & UTILIZE PHOTOS OR VIDEO OF ME OR MY PROPERTY FOR PURPOSES OF PROMOTING, MARKETING, & ADVERTISING THE COLLEGE. I UNDERSTAND & AGREE THAT PHOTOS OR LIKENESSES OF ME OR MY PROPERTY MAY APPEAR IN PRINT, ON TELEVISION, OR ON THE WEB, & THAT I WILL RECEIVE NO COMPENSATION. *MY SIGNATURE AUTHORIZES RCC TO RELEASE (WHEN REQUIRED) A REPORT INDICATING THAT I HAVE SUCCESSFULLY COMPLETED ALL REQUIREMENTS (ATTENDANCE, WRITTEN, & PRACTICAL TESTS) FOR CERTIFICATION. *ADMISSION TO ANY & ALL EDUCATIONAL PROGRAMS OFFERED BY RCC I MADE WITHOUT REGARD TO RACE, COLOR, SEX, RELIGION, AGE, DISABILITY, OR NATIONAL ORIGIN. FOR TITLE IX QUESTIONS, CALL 910-272-3505.

LIST CLASS NUMBERS ONLY

(Students will be emailed by January 28th if 1st choice is unavailable.)

1st Choice: _____ 2nd Choice: _____ 3rd Choice: _____ 4th Choice: _____

CREDIT CARD INFORMATION

Note: If paying by credit card, information must be provided below.

____ MasterCard ____ Visa

Card # _____ Exp. Date _____ 3-digit code _____

Card Holder's Name _____ Authorized Signature _____

Total Amount \$ _____ Payment Date _____ Phone _____

Student name

Department

Name of Training Officer or Chief completing this form

The 2018 edition of NFPA Standard 1403 requires that: "Students participating in live fire training evolution who have received the required minimum training and prerequisites from other than the authority having jurisdiction shall not be permitted to participate in any live fire training evolution without presenting prior written evidence of having successfully completed the prescribed minimum training to the levels specified in 4.3.1 (required minimum training) and 4.3.2.1 through 4.3.2.5 (prerequisites)." These required minimum training subjects (4.3.1) and prerequisites (4.3.2) are:

- | | | | |
|--|--------------------------|--|--------------------------|
| 1. 4.3.1 - Safety | <input type="checkbox"/> | 9. 4.3.1 - Ventilation | <input type="checkbox"/> |
| 2. 4.3.1 - Fire Behavior | <input type="checkbox"/> | 10. 4.3.1 - Forcible Entry | <input type="checkbox"/> |
| 3. 4.3.1 - Portable Extinguishers | <input type="checkbox"/> | 11. 4.3.1 - Building Construction | <input type="checkbox"/> |
| 4. 4.3.1 - Personal Protective Equipment | <input type="checkbox"/> | 12. 4.3.2.1 - Fire Dynamics | <input type="checkbox"/> |
| 5. 4.3.1 - Ladders | <input type="checkbox"/> | 13. 4.3.2.2 - Health and Safety | <input type="checkbox"/> |
| 6. 4.3.1 - Fire Hose, Appliance, and Streams | <input type="checkbox"/> | 14. 4.3.2.3 - Fundamentals of Fire Behavior | <input type="checkbox"/> |
| 7. 4.3.1 - Overhaul | <input type="checkbox"/> | 15. 4.3.2.4 - Fire Development in a Compartment | <input type="checkbox"/> |
| 8. 4.3.1 - Water Supply | <input type="checkbox"/> | 16. 4.3.2.5 - Nozzle Techniques and Door Control | <input type="checkbox"/> |

The Fire Chief or Training Officer of _____ Department authorizes that _____ has completed the required minimum training and prerequisites and may participate in the live fire training evolutions delivered by any NCFRC approved Delivery Agency and/or led by any NCFRC qualified live fire instructor.

Student, or participant, shall be at least 18 years of age to participate in live fire delivered by any NCFRC approved Delivery Agency and/or led by any qualified live fire instructor. ID's will be checked by qualified instructors before allowing students to participate in the live fire training. Signatures below validates that the student is at least 18 years old and have successfully completed the above required minimum training and prerequisites.

Chief or Training Officer Signature**Date**

Instructor Signature**Date**

Student Signature**Date**

2021 Vendors





AEST Safety
Atlantic Emergency Solutions
C.W. Williams and Company
Bucket Brigade USA
Coastal Fire Equipment
Code 3 Insurance
East Coast Fire Apparatus
FirstNet
Graham Battery
Greenstate Pools
Civic Credit Union
NAFECO
Newton's Fire and Safety
Robeson County EMS
Robeson County Sheriff's Office
Select Custom Apparatus
Wally's Fire and Safety

***Thank you for supporting the Southeast Fire Rescue College and
Law Enforcement Expo!***

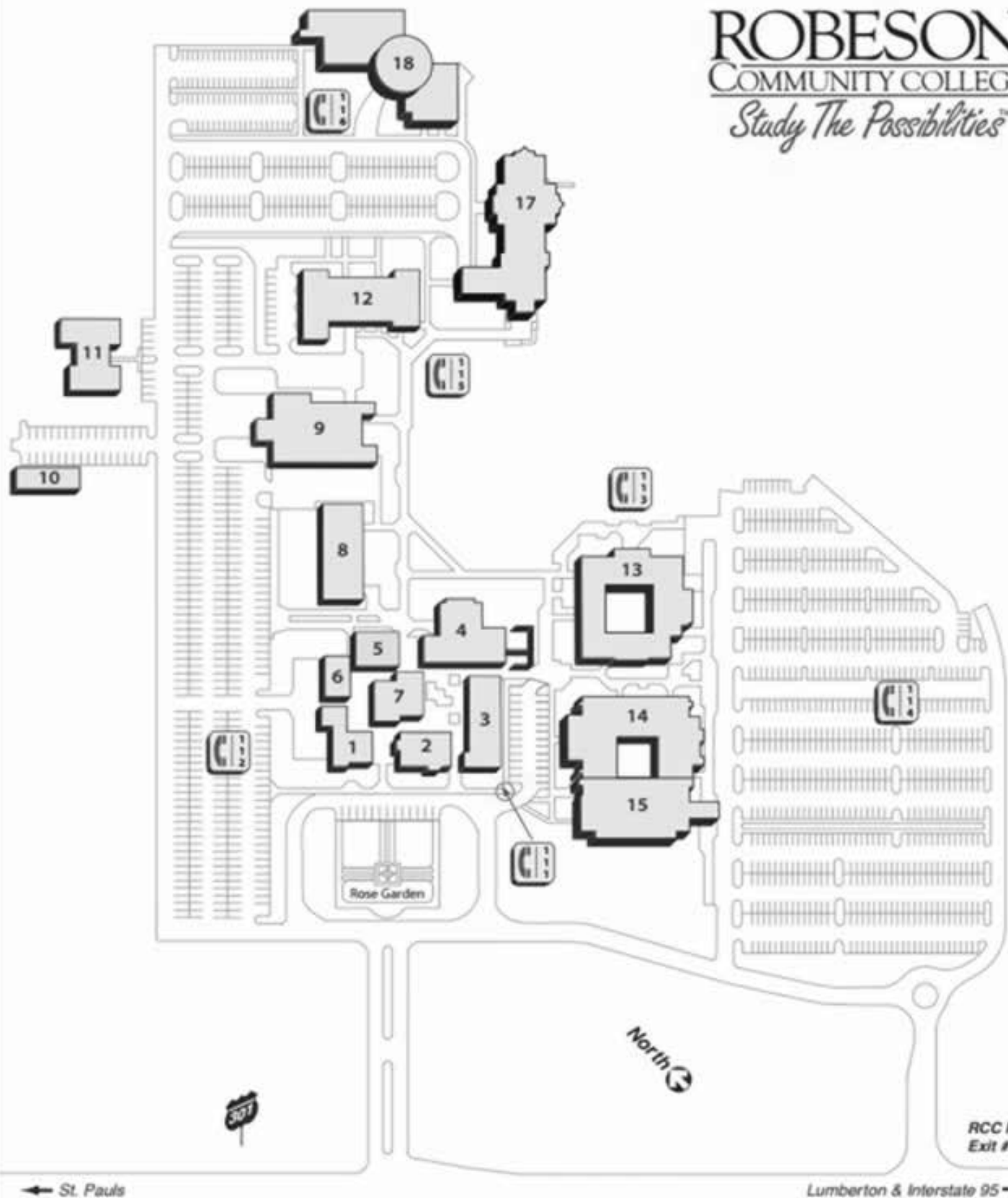
ROBESON COMMUNITY COLLEGE

Study The Possibilities™



-  Handicapped parking spaces in all lots
-  Emergency call boxes placed at strategic locations around campus
-  Video security surveillance
-  Visitor parking located in front of buildings 1 & 2, between buildings 3 & 14, in front of building 17

Dawn Drive

Notes

Photos from 47th Annual Southeast Fire/Rescue College



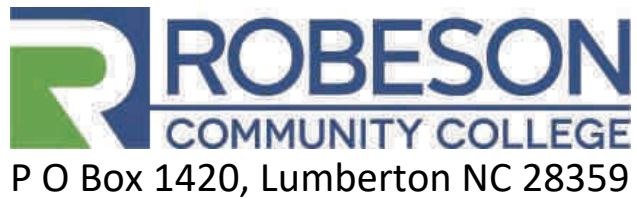

NON-PROFIT
US POSTAGE
PAID
COLUMBIA, SC
PERMIT #1183

For more information, call 910-272-3330
or visit our website at www.robeson.edu/fireedu



3,000 copies of this book were printed at a cost of \$1.06 per copy.

Robeson Community College is an Equal Opportunity Institution

2023 Southeast Fire/Rescue College & Law Enforcement Expo
February 8, 9, 10, 11, & 12